



# PRIVATE LABEL ON-THE-FLY FORM

## OVERVIEW

Farpointe offers quick, on-the-fly private label options for most readers and credentials. The private label options offer high quality artwork, do not require artwork-set-up fees and more importantly there are no minimum purchase order requirements or yearly commitments. Promote your company image by adding your company logo, URL or telephone number to every reader and credential that you supply. Please complete this form and send it to your access control sales representative to get started immediately.

## READERS

The majority of Farpointe's readers offer a recessed area on the covers or reader itself where a private label can be adhered. Different label materials and designs are available.

## CREDENTIALS

Farpointe Data can laser etch custom artwork to most credentials. Laser etchings offers a permanent and quality finish, but please note that laser etching does not offer color options (standard gray).

---

## CONTACT INFORMATION

Company Name: \_\_\_\_\_

Contact Person: \_\_\_\_\_

Title: \_\_\_\_\_

Phone: \_\_\_\_\_ Email: \_\_\_\_\_

---

## PRIVATE LABEL CODES

Label Name/Code: \_\_\_\_\_

Card/Fob Laser Code: \_\_\_\_\_

Issued By: \_\_\_\_\_ Date: \_\_\_\_\_

*Please see the following pages for the artwork requirements specific to readers and credentials.*

## READER PRIVATE LABELS

Most of Farpointe's readers have a recessed area where a private label can be adhered. The private label option is available with most Pyramid, Delta, Gibraltar and Guardian readers, as well as on the Ranger Transmitters and PSC-1 clamshell.

### SERVICE

Farpointe will order and supply the labels quantity ordered and sent to the company interested to adhere upon installation or once the product is received at their facility. Farpointe can add the labels at its facility for a fee.

### LABEL AREA:

0.90" W x 0.35" H and 0.06" radii

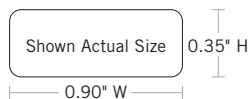

### LABEL TYPE:

- Flat
- Domed

### ARTWORK REQUIREMENTS:

Small text is not recommended due to the small surface area. For example:



### PREFERRED FILE TYPE:

Adobe Illustrator or .EPS file. Please provide the PMS color codes for accurate color matching. Preferred artwork should be at least 300dpi. If .EPS or Illustrator files are not available, some high-resolution JPEG files may be accepted.

### SEND ELECTRONICALLY:

Please email your artwork to support@farpointedata.com with subject 'Private Label.' Farpointe will produce an electronic proof of the label and supply it within 3-business days. Typical lead time for label production is two weeks plus transit time from the day the electronic proof is approved.

### OUTSIDE SUPPLIER

The labels may be sourced from a local supplier other than Farpointe. Most label manufacturers will require the artwork specifications.

### PRICING

Your Sales Representative will provide you with pricing.

# CREDENTIAL LASER ENGRAVING

Farpointe offers the option to permanently engrave standard credentials for quick customization. We can add a logo, text, URL or message. This option allows us to offer multiple artwork layouts per company (for example one version has your logo and another has your customer's). There are no set-up fees and no minimum order requirements like with other dye-sublimation or special printing programs.

## SERVICE

Farpointe will ship out samples of the laser engraved artwork within three to four business days from when the artwork is received. Once the samples are approved, Farpointe will generate a printing code for the samples approved and will use it to identify the requested artwork. The only requirement from the customer is to include the artwork code supplied on every purchase order that requires it.

## ARTWORK REQUIREMENTS

Please submit a high-resolution copy of your logo, artwork or text to support@farpointedata.com. A black and white version in Illustrator or .EPS file is preferred. Some high-resolution JPEGs may be accepted. Some complex logos may have to be modified for support from the laser engraver, but the capabilities are strong.

## CHOOSE THE TYPE OF CREDENTIALS

See examples below

- Clamshell models (PSC-1/DC1)
- PVC Material models without magnetic stripe (PSI-4, PSM-2P, DMC)
- Key Fob (PSK-3/DK1-3)
- PVC material models with magnetic stripe (PSM-2S/DMC-3S)
- Disc Tag PDT-1

## PRICING

Your Sales Representative will provide you with a quote per card.

## EXAMPLES

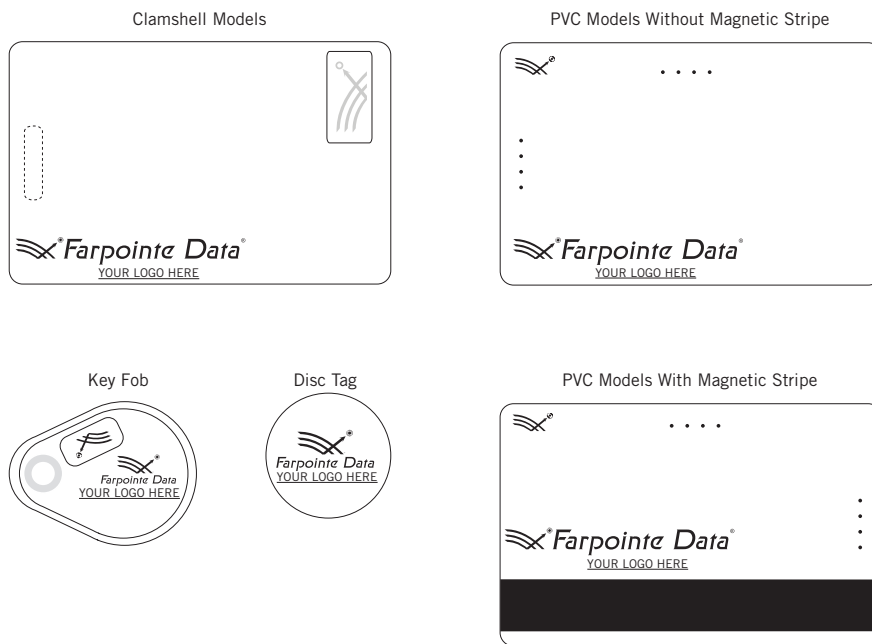

Farpointe Data reserves the right to change specifications without notice.

© 2015-2019 Farpointe Data, Inc. All rights reserved. Farpointe Data®, Pyramid Series Proximity®, Delta®, Ranger®, and CONEKT® are the registered U.S. trademarks of Farpointe Data, Inc. MIFARE is a registered trademark of NXP B.V. AWID is a trademark of Applied Wireless Identifications Group. HID is a registered trademark of HID Global Corporation, an ASSA ABLOY company. All other trademarks are the property of their respective owners.

**Farpointe Data, Inc.**  
 2195 Zanker Road  
 San Jose, CA 95131 USA  
 Office: +1-408-731-8700  
 Fax: +1-408-731-8705  
 support@farpointedata.com

